

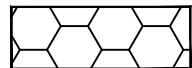



Key

-  Area of roadworks (A420 Closed)
-  Primary Diversion Route HGV'S over 7.5tones (A34/M4)
-  Secondary Diversion Route (A417 East/A4185 South/A34 South/M4 West)
-  Existing permanent 13m Length Limit (A361 on bridge near Lechlade)
-  Existing permanent 7.5T Weight Limit (B4019 on bridge near Coleshill Village)

| Rev. | Date | Purpose of revision | Drawn | Checked | Approved |
|------|------|---------------------|-------|---------|----------|
| | | | | | |



OXFORDSHIRE COUNTY COUNCIL
 Mark Kemp
 Deputy Director - Commercial
 Environment and Economy
 Oxfordshire County Council
 Speedwell House
 Speedwell Street
 Oxford
 OX1 1NE
 Tel: (01865) 815700
 Fax: (01865) 241577

Project title
**A420 SHRIVENHAM BYPASS
 MAJOR MAINTENANCE**

Drawing title
**TEMPORARY TRAFFIC ORDERS
 PUBLICITY PLANS
 SHEET 1 OF 3**

Drawing Status INFORMATION

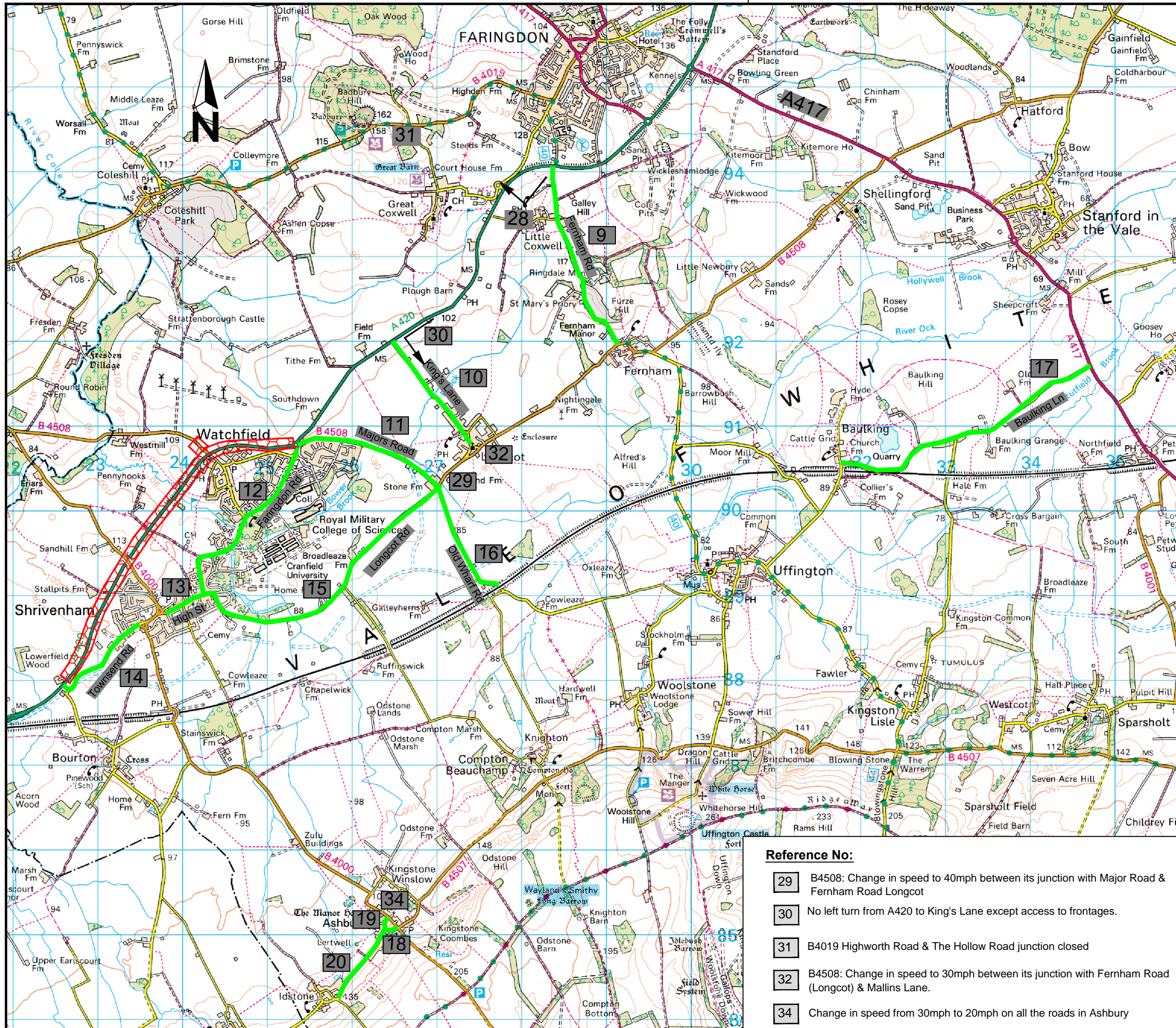
| | | | |
|------------|---------------------|-----------------------|------------------------|
| Scale @ A3 | Drawn by SM | Checked by AMM | Approved by PAR |
| N.T.S | Date drawn 24.03.14 | Date checked 01.04.14 | Date approved 01.04.14 |



Key

 Area of roadworks (A420 Closed)

 7.5T Weight Limit
TTRO Ref: 9 - 20

- Reference No:**
- 9 Fernham Road: 7.5T weight limit full length of the road
 - 10 King's Lane: 7.5T weight limit full length of the road
 - 11 Majors Road: 7.5T weight limit full length of the road
 - 12 Faringdon Rd: 7.5T weight limit full length of the road
 - 13 High Street: 7.5T weight limit full length of the road
 - 14 Townsend Rd: 7.5T weight limit full length of the road
 - 15 Longcot Rd: 7.5T weight limit full length of the road
 - 16 Old Wharf Rd: 7.5T weight limit full length of the road
 - 17 Baulking Ln :7.5T weight limit full length of the road
 - 18 High Street Ashbury :7.5T weight limit full length of the road
 - 19 Chapel Rd Ashbury :7.5T weight limit full length of the road
 - 20 Idstone Rd:7.5T weight limit full length of the road
 - 28 No right turn from A420 to Great Coxwell Road except access to frontages only.

| Rev. | Date | Purpose of revision | Drawn | Checked | Approved |
|------|----------|-------------------------|-------|---------|----------|
| C | 15.05.14 | TTRO Reference 34 added | SM | PAR | PAR |
| B | 29.04.14 | TTRO Reference 32 added | SM | PAR | PAR |
| A | 25.04.14 | TTRO Reference 31 added | SM | PAR | PAR |

 **OXFORDSHIRE COUNTY COUNCIL**

Mark Kemp
Deputy Director - Commercial
Environment and Economy
Oxfordshire County Council
Speedwell House
Speedwell Street
Oxford
OX1 1NE
Tel: (01865) 815700
Fax: (01865) 241577

Project title
**A420 SHRIVENHAM BYPASS
MAJOR MAINTENANCE**

Drawing title
**TEMPORARY TRAFFIC ORDERS
PUBLICITY PLANS
SHEET 2 OF 3**

Drawing Status INFORMATION

| | | | |
|------------|------------|--------------|---------------|
| Scale @ A3 | Drawn by | Checked by | Approved by |
| N.T.S | SM | AMM | PAR |
| | Date drawn | Date checked | Date approved |
| | 24.03.14 | 01.04.14 | 01.04.14 |

- Reference No:**
- 29 B4508: Change in speed to 40mph between its junction with Major Road & Fernham Road Longcot
 - 30 No left turn from A420 to King's Lane except access to frontages.
 - 31 B4019 Highworth Road & The Hollow Road junction closed
 - 32 B4508: Change in speed to 30mph between its junction with Fernham Road (Longcot) & Mallins Lane.
 - 34 Change in speed from 30mph to 20mph on all the roads in Ashbury

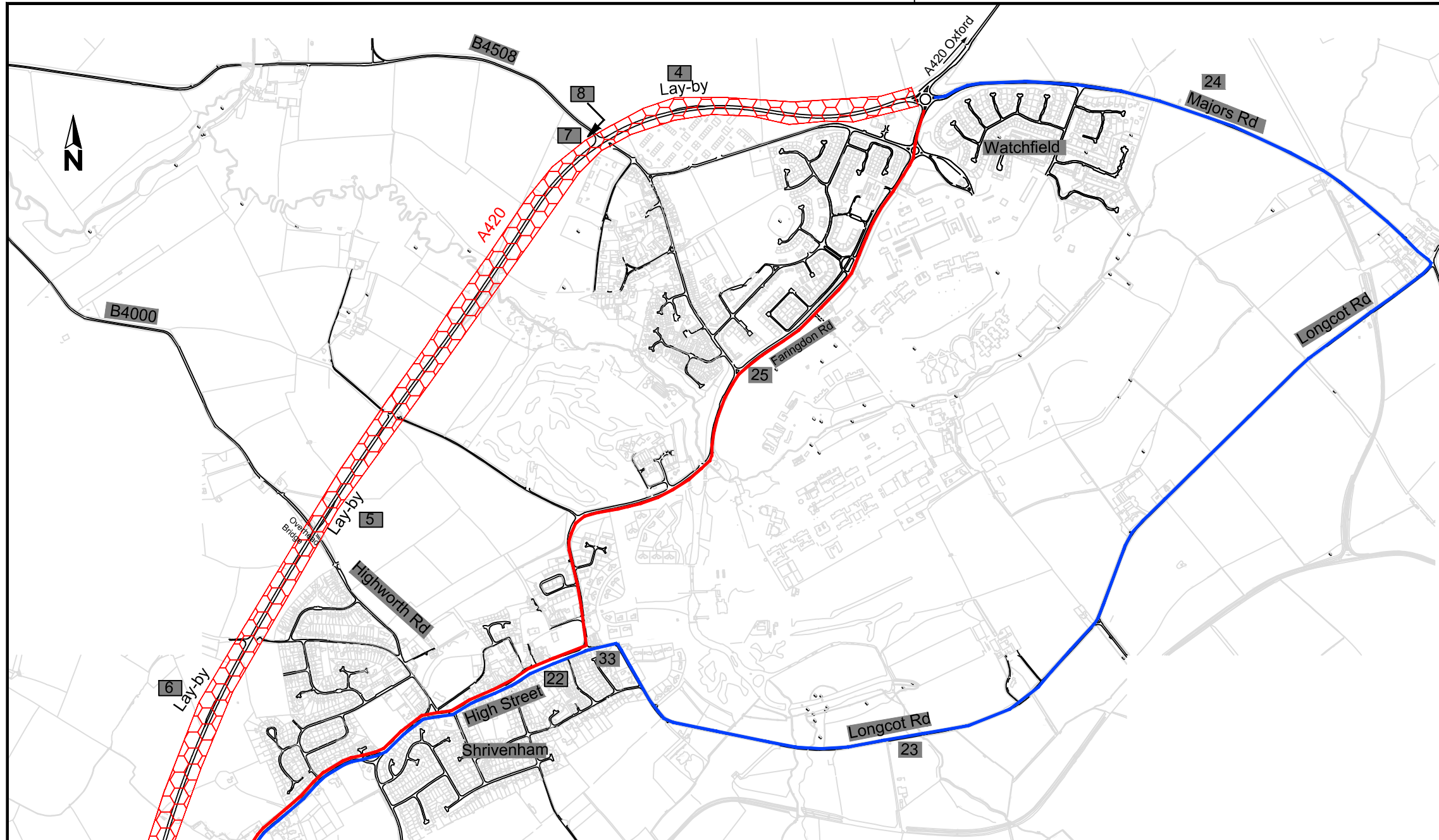

Reference No:

- 4 Close Oxford bound Lay-by between Watchfield Rbt and B4508 Junction.
- 5 Close Swindon bound Lay-by near B4000 overhead bridge.
- 6 Close Oxford bound Lay-by between B4000 overhead bridge and Lower Bourton Junction.
- 7 A420 & B4508 Junction closed
- 8 Suspend right turn from B4508 to A420
- 21 Suspend right turn from Townsend Road to A420
- 22 Change in speed to 20mph
- 23 Change in speed to 40mph
- 24 Change in speed to 40mph
- 25 Change in speed to 30mph
- 27 Suspend left turn from A417 Lechlade Road to Snowswick Ln except access to frontages.
- 33 No parking & waiting on Longcot Road between its junction with High Street & Vicarage Lane.

| Rev. | Date | Purpose of revision | Drawn | Checked | Approved |
|------|----------|---------------------------|-------|---------|----------|
| B | 13.06.14 | TTRO Reference 26 deleted | SM | PAR | PAR |
| A | 15.05.14 | TTRO Reference 33 added | SM | PAR | PAR |

Mark Kemp
Deputy Director - Commercial
Environment and Economy
Oxfordshire County Council
Speedwell House
Speedwell Street
Oxford
OX1 1NE
Tel: (01865) 815700
Fax: (01865) 241577

Project title
**A420 SHRIVENHAM BYPASS
MAJOR MAINTENANCE**

Drawing title
**TEMPORARY TRAFFIC ORDERS
PUBLICITY PLANS
SHEET 3 OF 3**

Drawing Status INFORMATION

| | | | |
|------------|------------|--------------|---------------|
| Scale @ A3 | Drawn by | Checked by | Approved by |
| N.T.S | SM | AMM | PAR |
| | Date drawn | Date checked | Date approved |
| | 24.03.14 | 01.04.14 | 01.04.14 |

Key

- Area of roadworks (A420 Closed)
- Temporary traffic signals.
- Local Diversion Route
Oxford to Swindon bound traffic only
- Local Diversion Route
Swindon to Oxford bound traffic only

